

neffos

Quick Start Guide

TP-LINK

CONTENTS

English	1
Deutsch	3
Español	5
Ελληνικά	7
Français	9
Italiano	11
Português	13

First glance

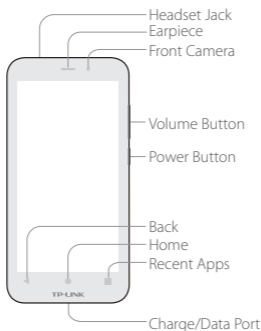

Getting started

1. Remove the back cover.

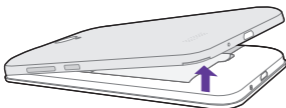

2. Insert the Micro SIM cards and microSD card (optional).

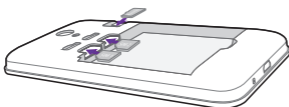

3. Insert the battery.

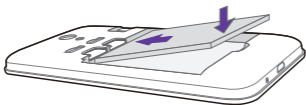

4. Replace the back cover.

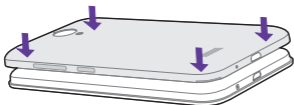

Charging

Connect the device to a power outlet using the included cable and USB power adapter.

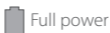
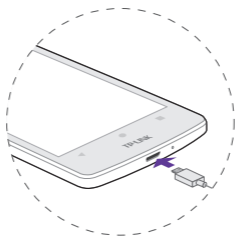

- For GPL source code, please visit <http://www.neffos.com/en/support/gpl-code>.

Überblick

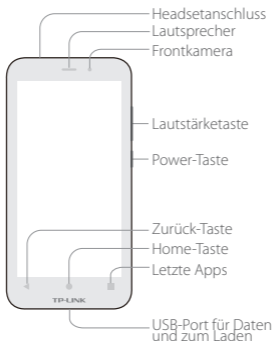

Erste Schritte

1. Entfernen Sie die Abdeckung auf der Gehäuserückseite.

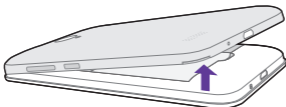

2. Legen Sie die Micro-SIM-Karte(n) und (optional) eine MicroSD-Karte ein.

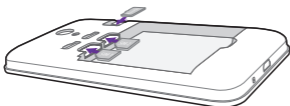

3. Legen Sie den Akku ein.

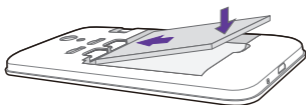



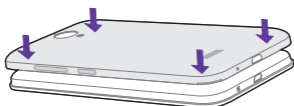

4. Bringen Sie die Abdeckung an.

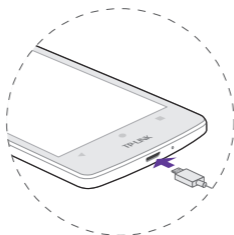

Aufladen

Verbinden Sie das Gerät mittels des mitgelieferten USB-Kabels mit einem spannungsführenden USB-Port (z.B. Computer oder Spannungsadapter).



 Akku schwach  Akku geladen  Wird geladen

- Die unter der GPL stehenden Quellcodes finden Sie unter <http://www.neffos.com/en/support/gpl-code>

Familiarizarse con el teléfono



Primeros pasos

1. Retire la tapa trasera.

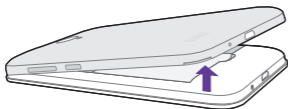

2. Inserte la(s) tarjeta(s) Micro-SIM y la tarjeta microSD (opcional).

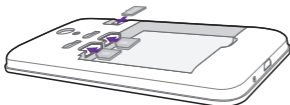

3. Inserte la batería.

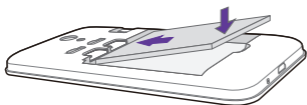

4. Vuelva a colocar la tapa trasera.

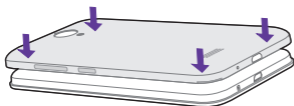

Carga

Conecte el dispositivo a una toma de corriente con el cable y el adaptador de alimentación USB incluidos.

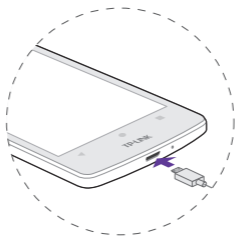

Batería baja



Carga completa



Cargando

- Para códigos fuente GPL, por favor visite <http://www.neffos.com/en/support/gpl-code>.

Με μια ματιά



Για να ξεκινήσετε

1. Αφαιρέστε το πίσω κάλυμμα.

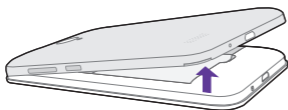

2. Τοποθετήστε κάρτα(ες) Micro-SIM και κάρτα microSD (προαιρετικά).

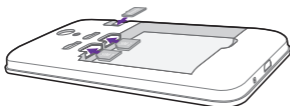

3. Τοποθετήστε τη μπαταρία.

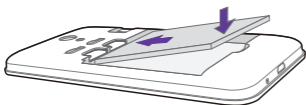

4. Τοποθετήστε ξανά το πίσω κάλυμμα.

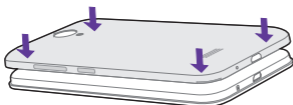

Φόρτιση

Συνδέστε τη συσκευή στην πρίζα χρησιμοποιώντας τον παρεχόμενο φορτιστή και καλώδιο USB.

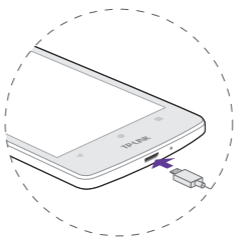

 Χαμηλή μπαταρία  Πλήρως φορτισμένο  Φορτίζει

- Για να δείτε τον πηγαίο κώδικα GPL, παρακαλούμε επισκεφθείτε την ιστοσελίδα <http://www.neffos.com/en/support/gpl-code>.

Premiers pas

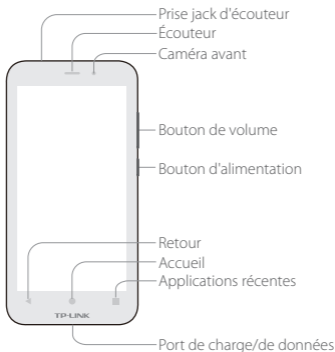

Mise en route

1 Retirez la coque arrière.

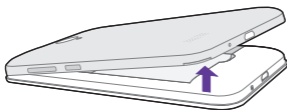

2 Insérez la(les) carte(s) Micro SIM et la carte microSD (facultatif).

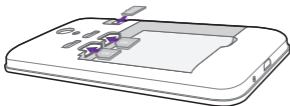

3 Insérez la batterie.

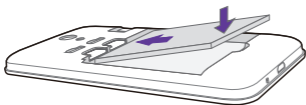

4 Remplacez la coque arrière.

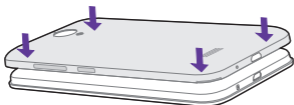

Chargement

Branchez l'appareil à une prise d'alimentation grâce au câble et à l'adaptateur USB fournis.

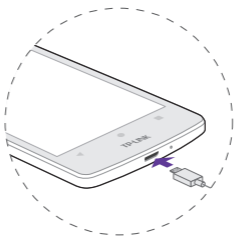

 Batterie faible  Batterie pleine  Chargement

- Pour obtenir le code source de la licence GPL, veuillez utiliser le lien <http://www.neffos.com/fr/support/gpl-code>.

Panoramica

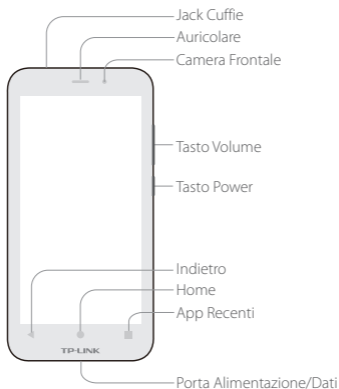

Per iniziare

1. Rimuovete la cover posteriore.

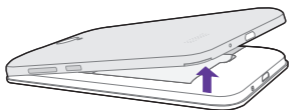

2. Inserite la SIM card Micro e la card microSD (opzionale).

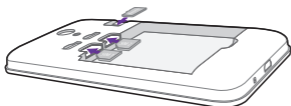

3. Inserite la batteria.

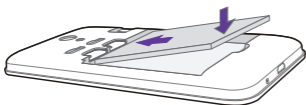

4. Riposizionate la cover posteriore.

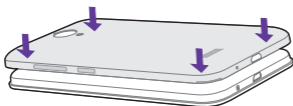

Messa in carica

Collegate il dispositivo ad una fonte di alimentazione usando il cavo incluso e l'alimentatore USB.

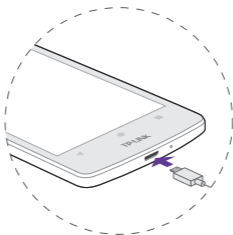

Batteria con poca carica



Batteria a piena carica



In carica

- Per il codice sorgente GPL, andate in <http://www.neffos.com/en/support/gpl-code>.

Descrição do Dispositivo

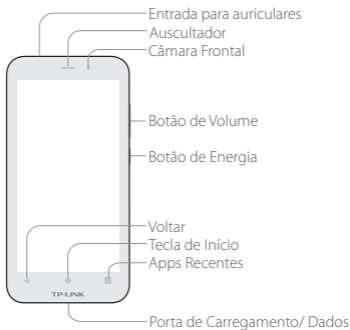

Começar

1. Remover a capa traseira.

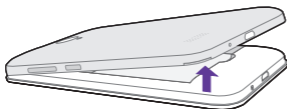

2. Inserir o(s) cartão(ões) Micro SIM e o cartão microSD (opcional).

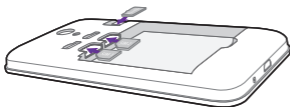

3. Inserir a bateria.

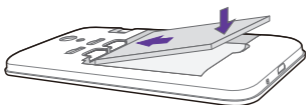

4. Voltar a colocar a capa traseira.

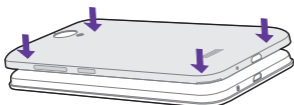

Carregamento

Ligar o dispositivo a uma tomada elétrica utilizando o cabo incluído e um adaptador de energia USB.

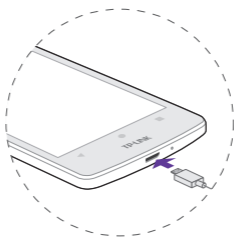

 Bateria fraca  Totalmente carregada  A carregar

- Para obter o código GPL, por favor visite <http://www.neffos.com/en/support/gpl-code>.

- For more information, please visit: www.neffos.com
- Contact our technical support if you have any questions related to this product: support@neffos.com
- Android is a trademark of Google Inc.